

Reproduced from based upon the Ordnance Survey mapping with permission of the Controller of Her Majesty's Stationary Office. Unauthorised reproduction infringes Crown copyright and may lead to prosecution or civil proceedings.
 © Crown copyright and database rights (2018) Ordnance Survey (100018466)

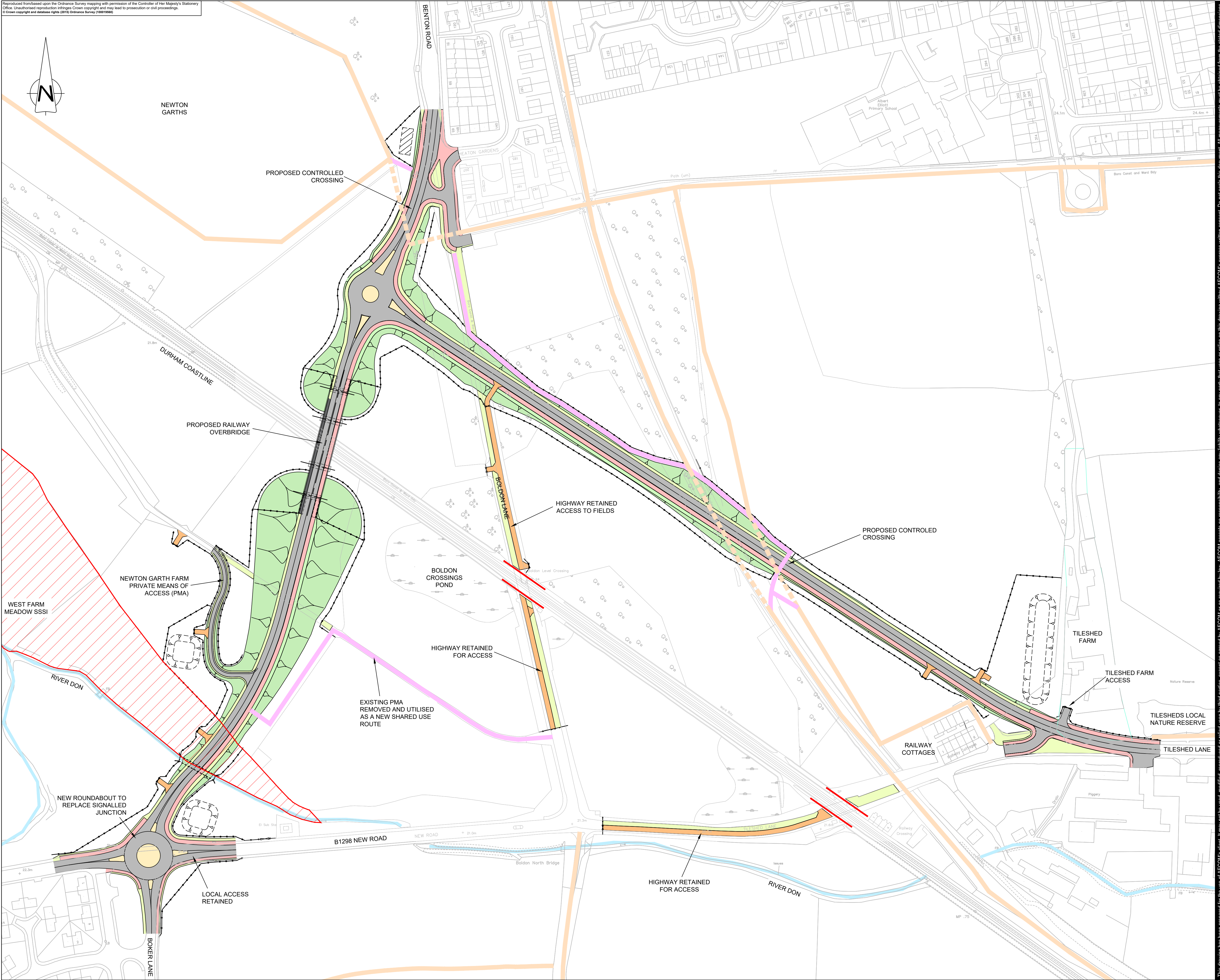

NOTES

LEGEND

- PROPOSED SHARED USE PATH WITH ADJACENT VERGE FOR EQUESTRIAN USE
- PROPOSED PUBLIC RIGHT OF WAY OR OTHER PUBLIC PATH
- EXISTING PUBLIC RIGHT OF WAY OR OTHER PUBLIC PATH RETAINED
- EXISTING PUBLIC RIGHT OF WAY OR OTHER PUBLIC PATH TO BE CLOSED

INFORMATION



ISSUE/REVISION

NO.	DATE	DESCRIPTION
P01	2020.10.02	ISSUE TO WEBSITE GA
I/R		

CLIENT

South Tyneside Council
 TOWN HALL & CIVIC OFFICES
 WESTOE ROAD, SOUTH SHIELDS
 TYNE & WEAR, NE33 2RL

PROJECT

**BOLDON & TILESHED
 LEVEL CROSSINGS**

SHEET TITLE

**WESTERN ROUTE
 GENERAL ARRANGEMENT**

CONSULTANT

AECOM
 One Trinity Gardens
 Newcastle upon Tyne
 0191 224 6500 tel 0191 224 6599 fax
 www.aecom.com

SHEET NUMBER

60603769-ACM-HGN-WR-DR-CH-016

This drawing has been prepared for the use of AECOM's client. It may not be used, modified, reproduced or relied upon by third parties, except as agreed by AECOM or as required by law. AECOM accepts no responsibility, and denies any liability, whatsoever, to any party that uses or relies on this drawing without AECOM's express written consent. Do not scale this document. All measurements must be obtained from the stated dimensions.